

# ADVANCED FRAMELESS SINGLE GLAZING SYSTEM

## INSTALLATION GUIDELINE

### CEILING CHANNEL

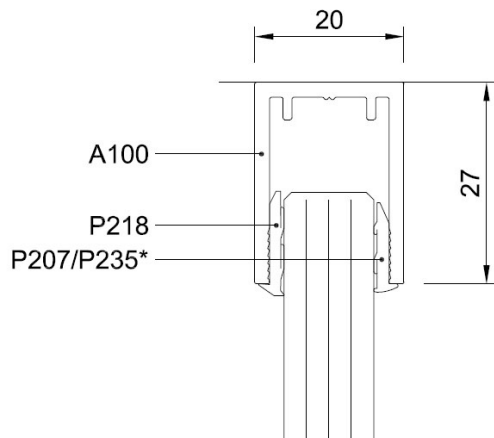

### FLOOR CHANNEL

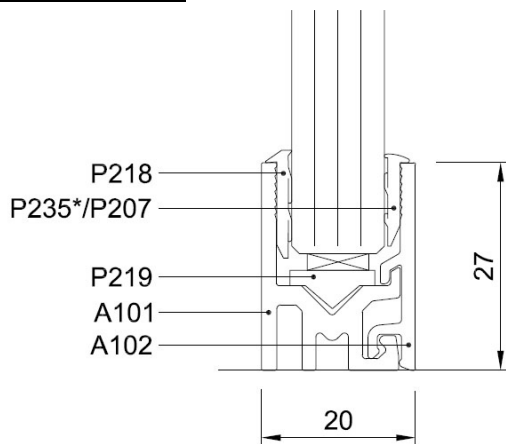

### ABUTMENTS

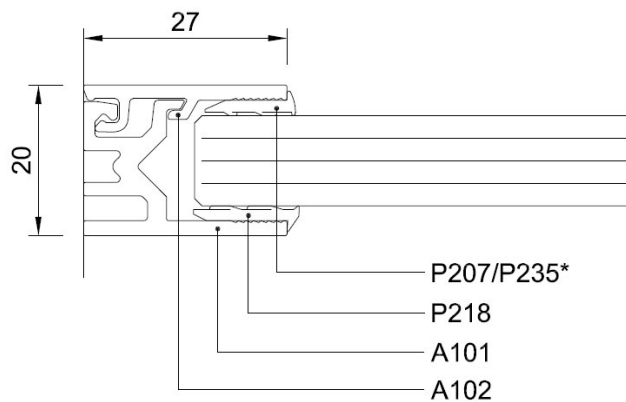

## **DOOR JAMB**

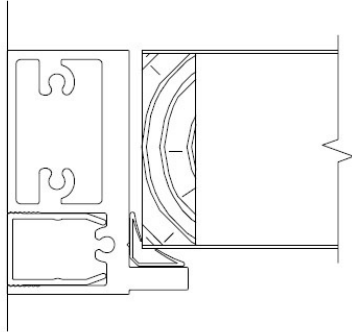

44mm TIMBER DOOR LEAF

## **SINGLE GLAZING STEP BY STEP INSTALLATION**

**Step 1.** Mark position of door frame Ref. A104 on the ceiling or drywall lintel if used (Ceiling must be re-enforced / braced properly to receive fixation of door frame & glazing system)

**Step 2.** Fix the ceiling track Ref. A100 (space between anchoring points vary from 450 to 600 mm c/c depending on glazed partition length)

**Step 3.** Plumb down and fix the floor track Ref. A101

**Step 4.** Fix abutments Ref. A101 (Ref. A100 could be used on one side and Ref. A101 on the other though Ref. A100 could be used on both sides if more than one glass panes are to be fixed but for easy fixation, Ref. 101 can be used for both abutments)

**Step 5.** Fit the door frame, if being used (Refer to door frame installation guidelines)

**Step 6.** Fit the neoprene gasket Ref. P218 on the same side of the Ref. A100 & A101 prior to installation of glass panes (Remove adhesive paper before fixing the gasket. It is important to ensure that the small lip on the gasket sits evenly on top of the channel leg)

**Step 7.** Fit the “V” spacers (P219) and any packers needed to level the inside if the floor tracks Ref. A101. 2 x “V” spacers per glass pane

**Step 8.** Install the glass pane / panes (Make sure the glass is supported by the “V” spacers and not on the aluminium base so as to avoid glass to chip)

**Step 9.** Fit the clear polycarbonate H section if more than one glass pane is used

**Step 10.** Fit the glazing clip Ref. A102 (Make sure the glazing clip clicks into the Ref. A101)

**Step 11.** Wet the glass with warm soapy water or glass cleaner and install the clear gaskets Ref. P207 / P235 (Gaskets are usually pushed into place by using fingers but sometimes need to be “persuaded” if glass is slightly thicker than 10mm or 12mm, a timber drift in conjunction with a wooden or rubber hammer could be used. It is important to ensure that the small lip on the gasket sits evenly on top of the channel leg. It is important not to stretch the gasket when fitting it as it might shrink so it is best to cut it slightly oversize and fit both ends first and then work towards the middle)

**Step 12.** Clean the glass after installation is complete

### **DOOR FRAME INSTALLATION**

**Step 1.** Cut / adjust door frame height as per site requirements

**Step2.** Place the Aluminium connectors to secure the door leg and head together

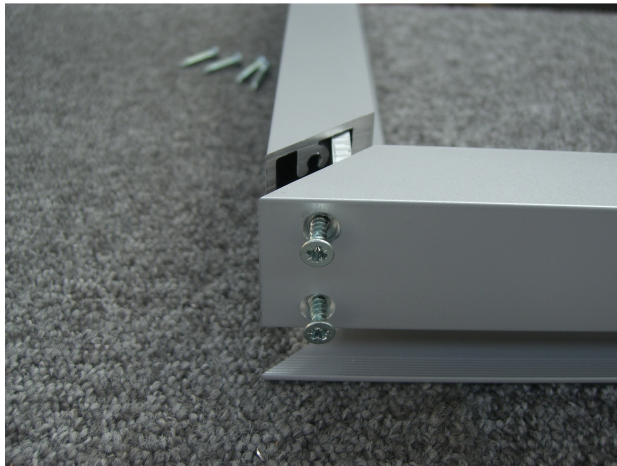

**Step 3.** Door frame to be drilled and countersunk on site to provide necessary fixing holes

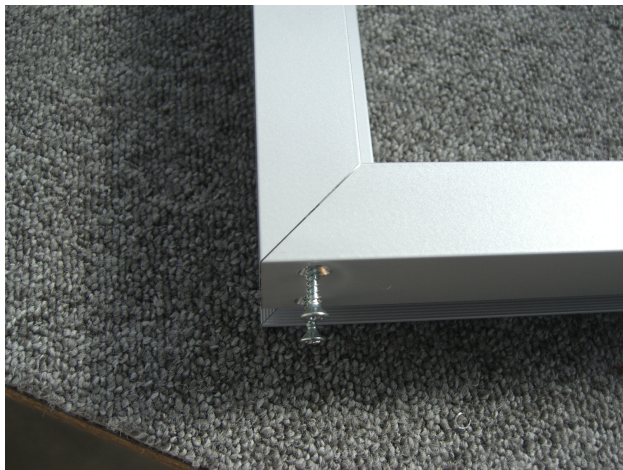

**Step 4.** Position the door frame in the opening, fix the L Shaped metal bracket to the frame and to the floor (bracket is usually covered by flooring / carpet unless)





**Step 5.** Fix the door frame with 60 mm screws where the batwing seals will be fitted. Fixation must be countersunk for the batwing seal to hide / cover the screw fixation heads properly

**Step 6.** Measure and cut batwing seal to door size requirements, remove adhesive paper and apply on the door frame

**NOTE:**

- Fixation to drywall & false ceilings to be done by using drywall screws (25 or 41 mm as required)
- Fixation to concrete floor to be done by using nail plugs
- Anchoring points to be pre-drilled & countersunk before fixation (not necessary for ceiling channel Ref. A100)
- Deflection head channels to be used to direct fixation on slab